

CS-0120-3
CT-0120-3

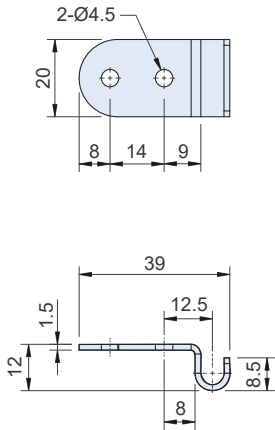

CS-0120-4
CT-0120-4

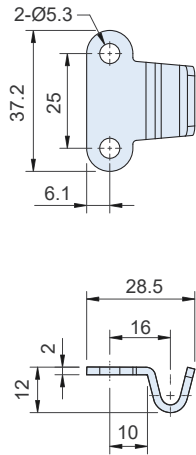

CS-0120-6
CT-0120-6

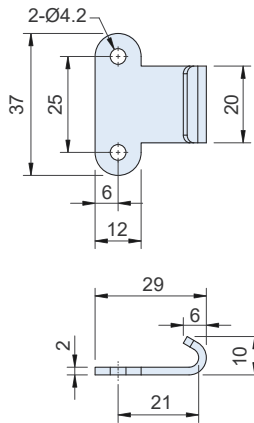

CS-0120-7
CT-0120-7

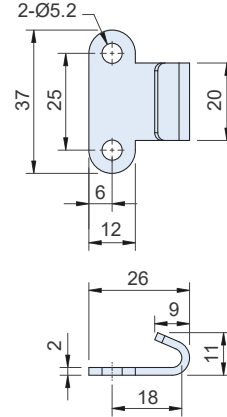

CS-111-2
CT-0412-2

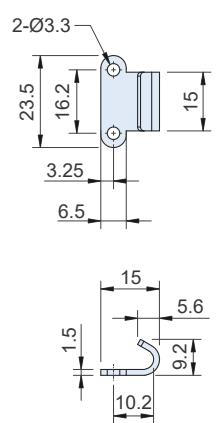

CS-22-2
CT-22-2

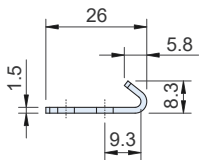
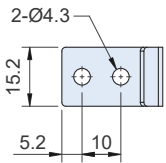

CS-22-3
CT-22-3

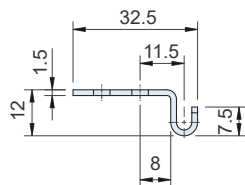
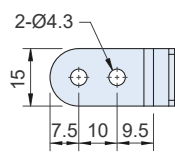

CS-00207-2
CT-00207-2

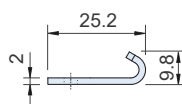
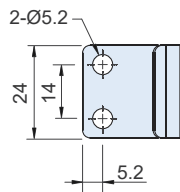

CS-27100-2
CT-27100-2

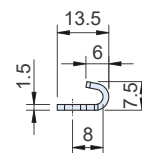
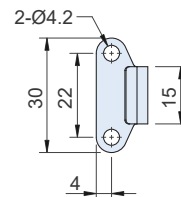

CS-1120-2
CT-1120-2

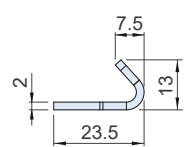
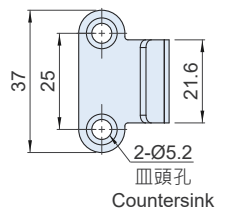

材質與表面處理

- CS系列：不銹鋼(SUS304) · 震動亮面。
- CT系列：鐵(SPCC) · 鍍鋅(符合RoHS規範)

MATERIAL AND FINISH

- CS Series: Stainless steel (SUS304), Vibration ground.
- CT Series: Steel (SPCC), Zinc plated.

CS-0210-2
CT-0210-2

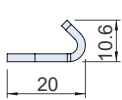
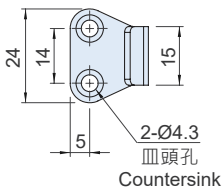

CS-0220-2
CT-0220-2

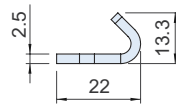
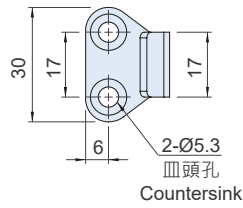

CS-0230-2
CT-0230-2

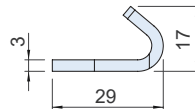
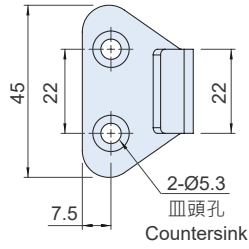

CS-0240-2
CT-0240-2

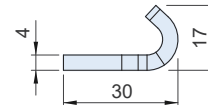
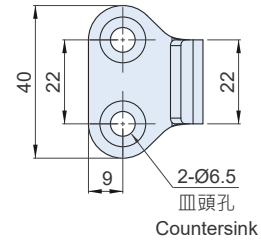

CS-0210-3

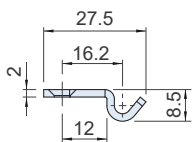
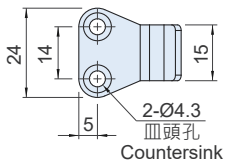

CS-0220-3

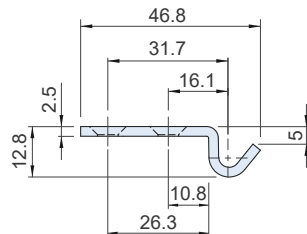
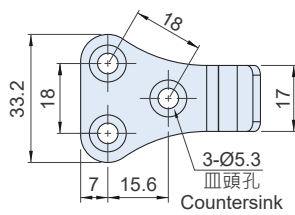

CS-0230-3

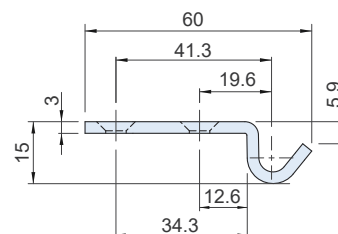
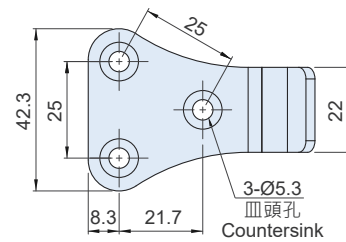

材質與表面處理

- CS系列：不銹鋼(SUS304) · 震動亮面 ·
- CT系列：鐵(SPCC) · 鍍鋅(符合RoHS規範)
- CT-0240-2：鐵(SPHC) · 鍍鋅(符合RoHS規範)

MATERIAL AND FINISH

- CS Series: Stainless steel (SUS304), Vibration ground.
- CT Series: Steel (SPCC), Zinc plated.
- CT-0240-2: Steel (SPHC), Zinc plated.