

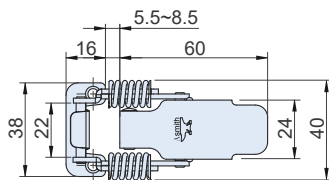

CS-0120 / CT-0120

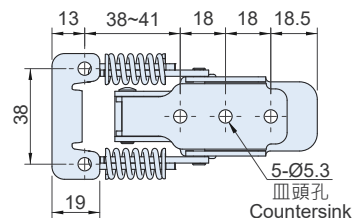

CS-0130 / CT-0130

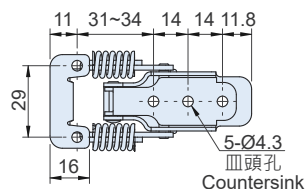
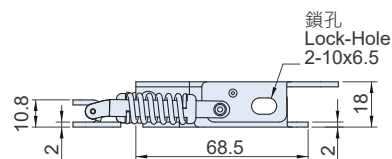
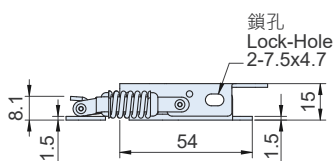
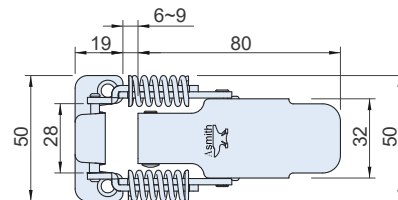

使用例
Example of application

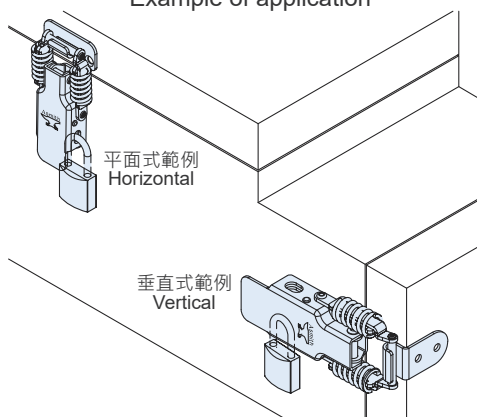

SPECIFICATION:

Unit:mm

產品編號 Item No.	材質 Material	表面處理 Finish	拉伸距離 \ 引張荷重 Extension Length \ Compression Force				重量 Weight (g)
			1 mm	2 mm	3 mm	4 mm	
CS-0120	SUS304	毛絲面 Brushed finish	22 kgf	27 kgf	33 kgf	38 kgf	69
CT-0120	SPCC	鍍鋅 Zinc Plated	28 kgf	36 kgf	41 kgf	47 kgf	71
CS-0130	SUS304	毛絲面 Brushed finish	28 kgf	34 kgf	41 kgf	44 kgf	136
CT-0130	SPCC	鍍鋅 Zinc Plated	29 kgf	36 kgf	40 kgf	50 kgf	140

特徵

- 兩邊有彈簧，具有迫緊式功能。
- 可用銅掛鎖阻絕彈開可能性及增加安全性。

FEATURES

- Both sides spring design with compression function.
- Standard Lock-hole can using with lock.

可替換鉤座 ALTERNATIVE KEEPERS:

產品編號 Item No.											
CS-0120-3 CT-0120-3	CS-0120-4 CT-0120-4	CS-0120-6 CT-0120-6	CS-0120-7 CT-0120-7	CS-1120-2 CT-1120-2	CS-0210-2 CT-0210-2	CS-0220-2 CT-0220-2	CS-0230-2 CT-0230-2	CS-0210-3	CS-0220-3	CS-0230-3	
CS-0120 CT-0120	●	●	●	●		●	●	●	●		
CS-0130 CT-0130	●	●			●		●			●	●

備註：詳細規格請參考76~77頁

Remark : Please refer to page 76~77 for specifications.

材質與表面處理

- CS系列：不銹鋼(SUS304)，震動亮面。
- CT系列：鐵(SPCC)，鍍鋅(符合RoHS規範)

MATERIAL AND FINISH

- CS Series: Stainless steel (SUS304), Vibration ground.
- CT Series: Steel (SPCC), Zinc plated.

CS-0120-3
CT-0120-3

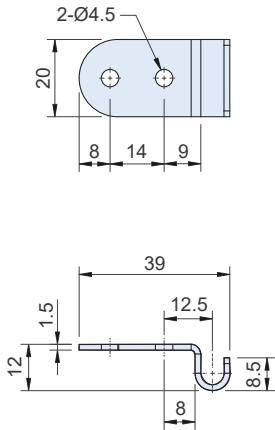

CS-0120-4
CT-0120-4

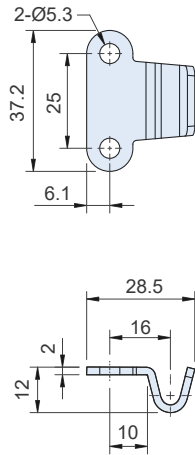

CS-0120-6
CT-0120-6

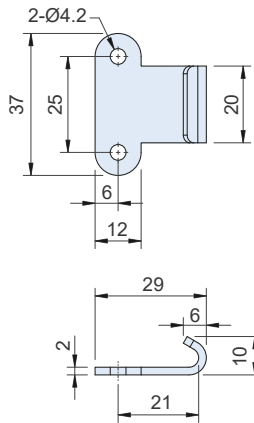

CS-0120-7
CT-0120-7

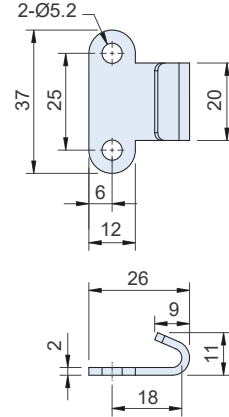

CS-111-2
CT-0412-2

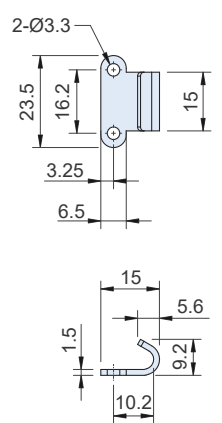

CS-22-2
CT-22-2

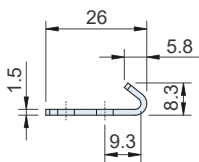
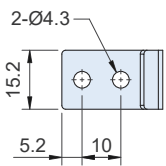

CS-22-3
CT-22-3

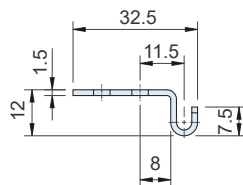
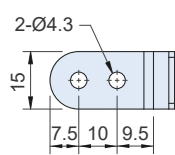

CS-00207-2
CT-00207-2

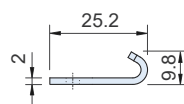
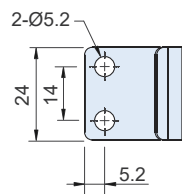

CS-27100-2
CT-27100-2

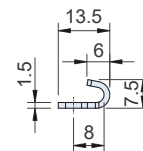
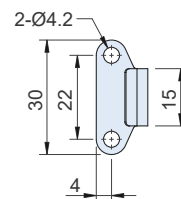

CS-1120-2
CT-1120-2

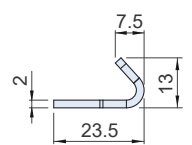
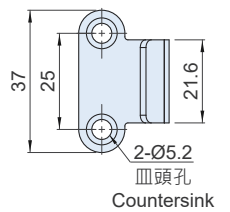

材質與表面處理

- CS系列：不銹鋼(SUS304) · 震動亮面。
- CT系列：鐵(SPCC) · 鍍鋅(符合RoHS規範)

MATERIAL AND FINISH

- CS Series: Stainless steel (SUS304), Vibration ground.
- CT Series: Steel (SPCC), Zinc plated.

CS-0210-2
CT-0210-2

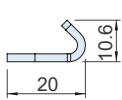
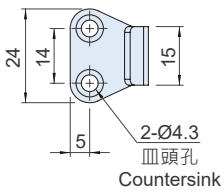

CS-0220-2
CT-0220-2

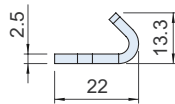
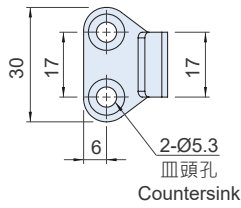

CS-0230-2
CT-0230-2

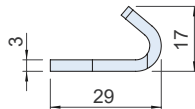
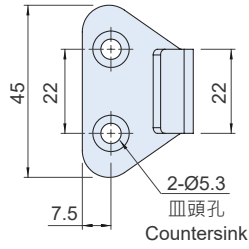

CS-0240-2
CT-0240-2

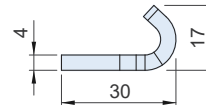
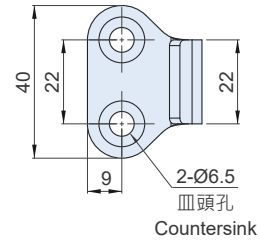

CS-0210-3

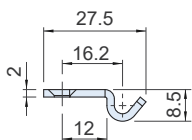
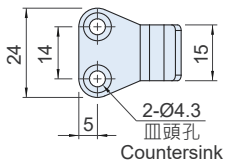

CS-0220-3

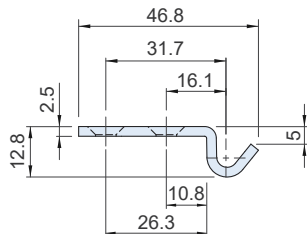
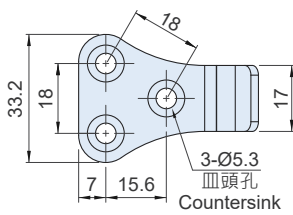

CS-0230-3

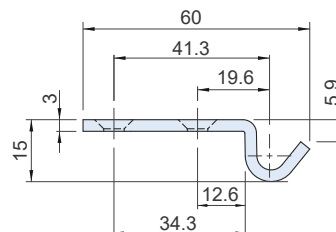
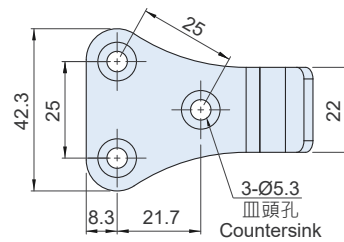

材質與表面處理

- CS系列：不銹鋼(SUS304) · 震動亮面 ·
- CT系列：鐵(SPCC) · 鍍鋅(符合RoHS規範)
- CT-0240-2：鐵(SPHC) · 鍍鋅(符合RoHS規範)

MATERIAL AND FINISH

- CS Series: Stainless steel (SUS304), Vibration ground.
- CT Series: Steel (SPCC), Zinc plated.
- CT-0240-2: Steel (SPHC), Zinc plated.